

Elevation View

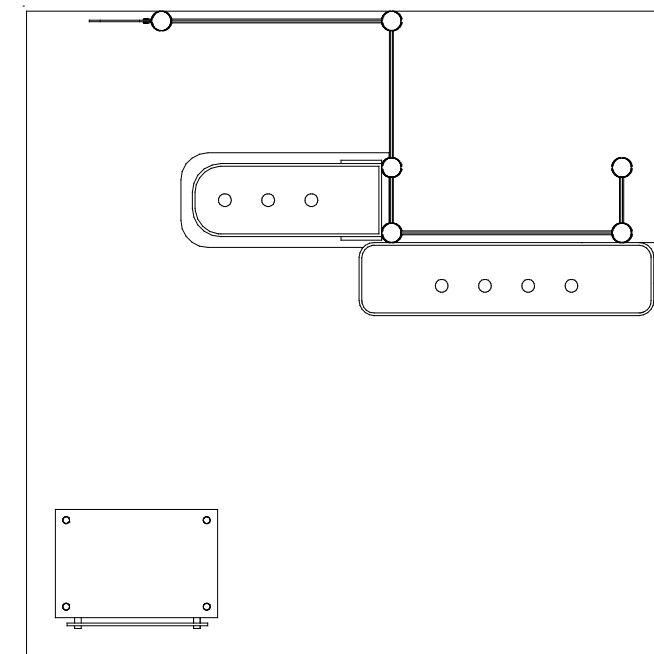

Plan View



SETUP INSTRUCTIONS

General Setup Instructions

- Read entire setup instruction manual prior to unpacking parts and pieces.
- The setup instructions are created specifically for this configuration.
- Setup instructions are laid out sequentially in steps, including exploded views with detailed explanation for assembly.

Cleaning & Packing

- For Cleaning Metal, Plex, & Laminate Parts: Use a **MILD NON-ABRASIVE** cleanser and soft cloth/paper towel to clean all surfaces.
- Keep exhibit components away from heat and prolonged sun exposure.
Heat and UV exposure will warp and fade components.
- Retain all provided Packing Materials. All provided packing materials are for ease of repacking & component protection.

Disassembly

- For loss prevention, tighten all setscrews and locks during disassembly

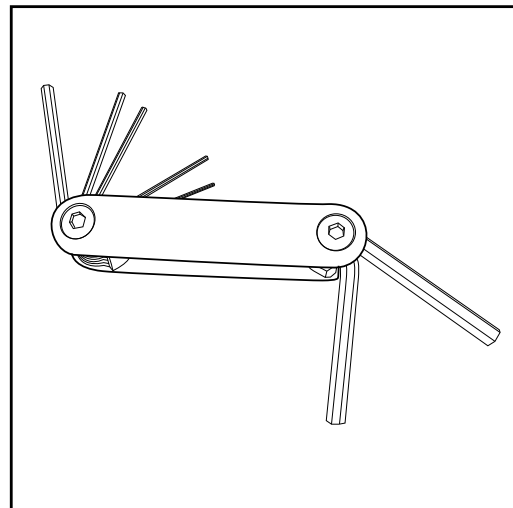

Hex Tool - Essential for Assembly

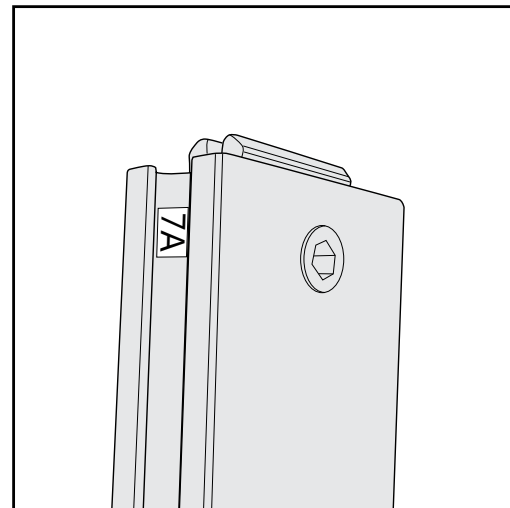

Part Identification - Numbering

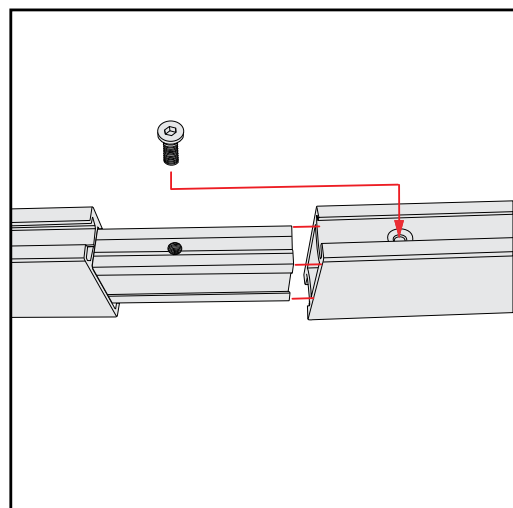

Spline Connection

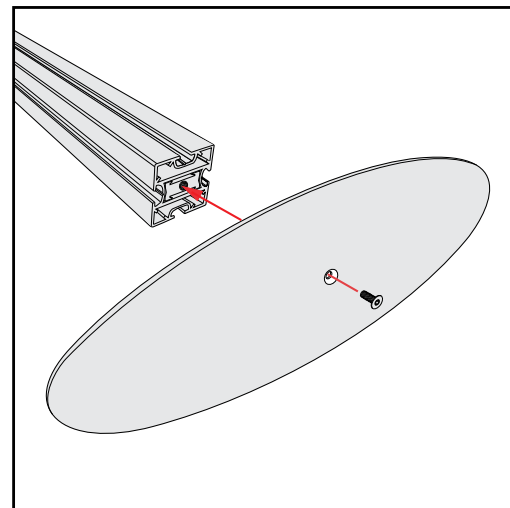

Base Plate & Extrusion Connection

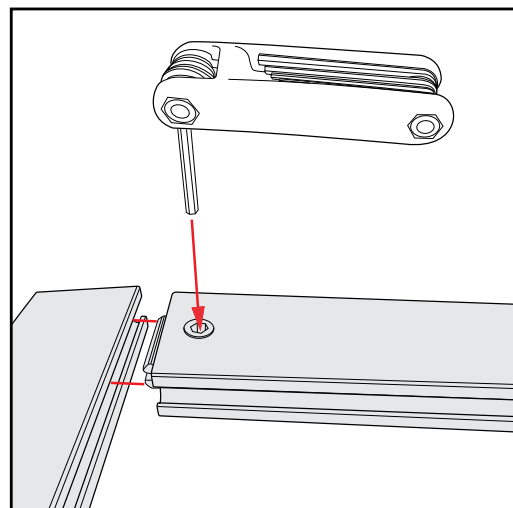

Extrusion & Lock Connection

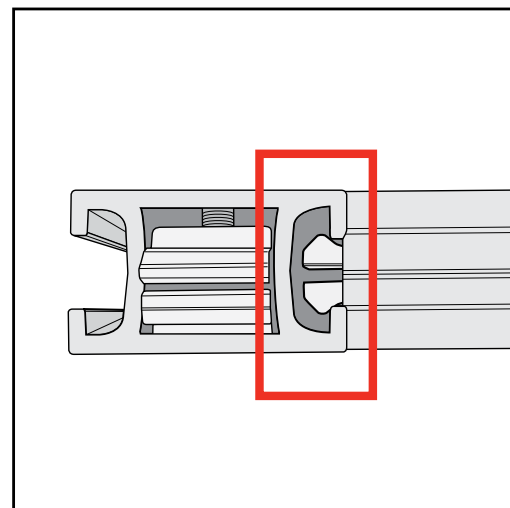

Engaged Lock



WARNING



DO NOT USE POWER TOOLS

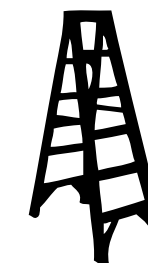

LADDERS OR LIFTS
MAY BE REQUIRED



ALL CONNECTIONS MUST
BE TIGHTLY SECURED

SEG Graphic Installation

- 1) Locate channels along the edges of extrusions
- 2) Insert graphic corners first into channels then center point of graphic into channels. Allows for proportional fit around the perimeter of the extrusion.
- 3) Working from center to corner, slide silicon edge on graphic into channel.
- 4) After all edges of graphic have been inserted into channels, step back and assess graphic fit, make adjustments where needed.

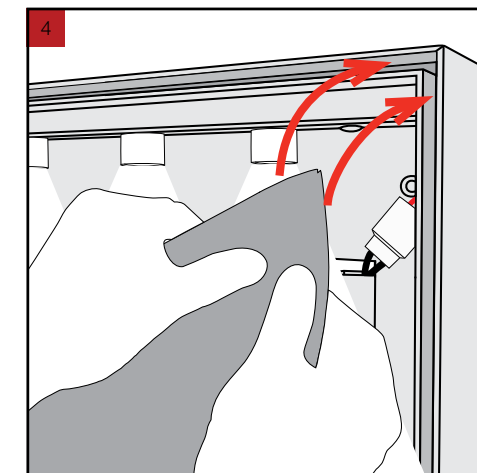
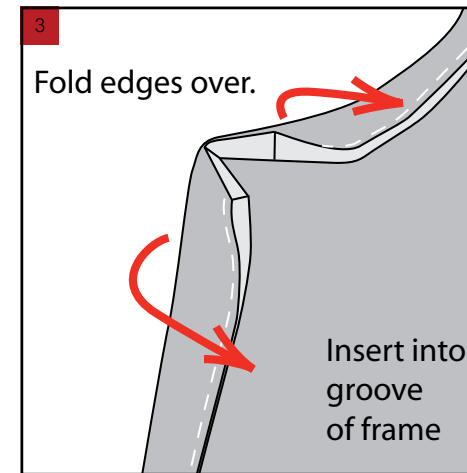
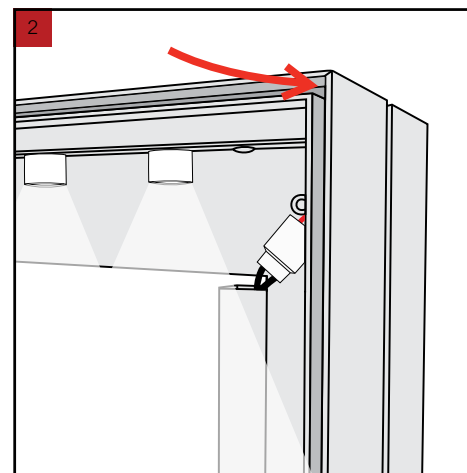
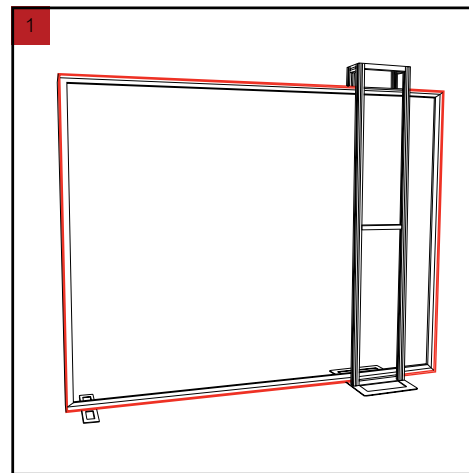

LT Panel Assembly

- 1) With a vertical offset, place LT-Panels side-by-side; slide vertically offset panel down to lock panels together and in place.
- 2) Corner Connectors (90°, T-Connector, Straight Connector) connect just as panels connect together. Repeat Step 1 for installing corner connectors to panels.

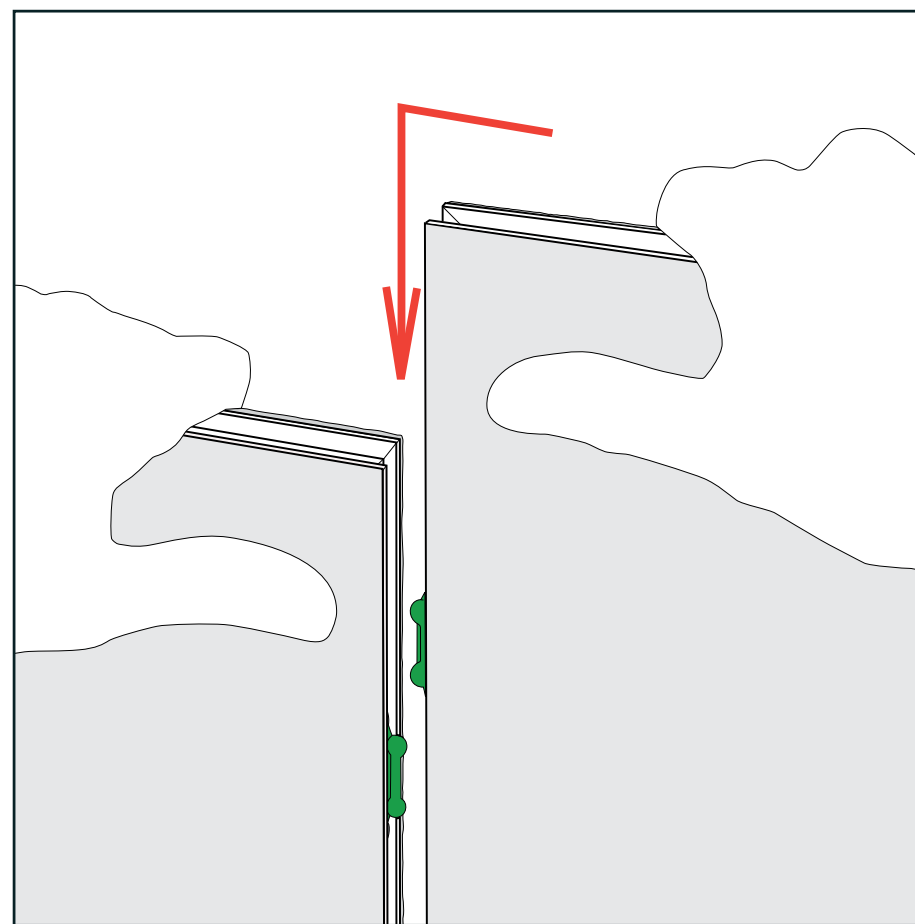

LT Panel Disassembly

- 1) To disassemble push panel with upper locks horizontally to disengage top lock clip.
- 2) Slide panels or connectors vertically in opposing directions to release latches and disconnect parts.

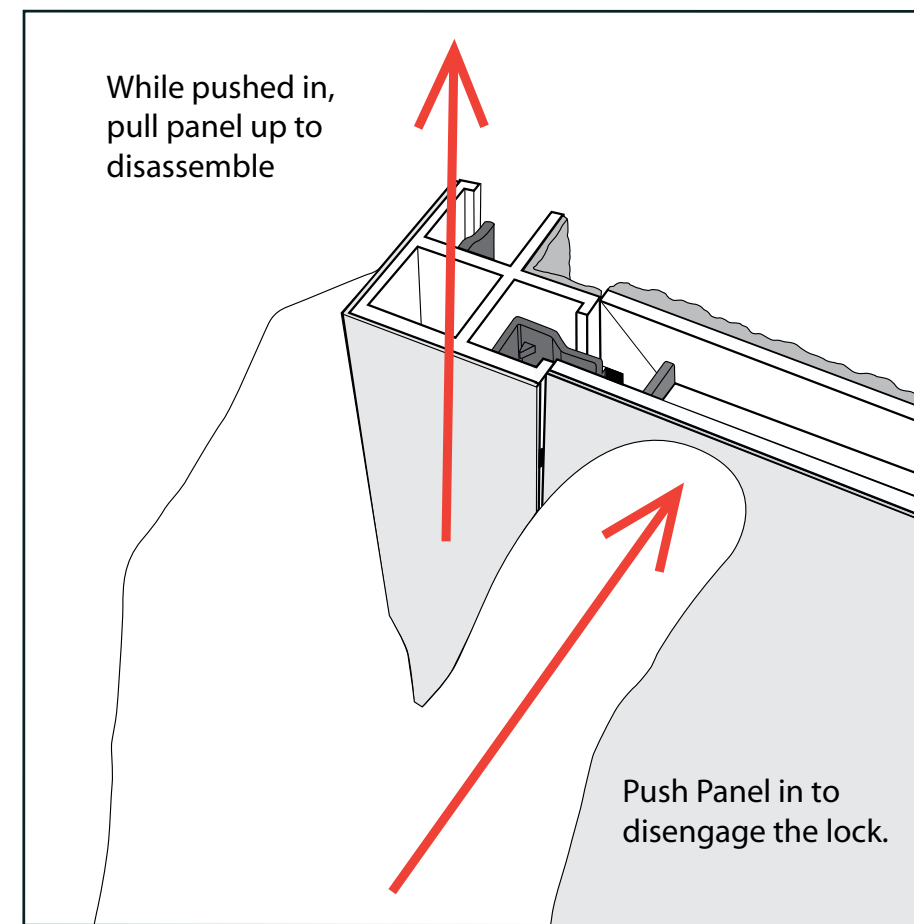

Item	Qty.	Description
1	1	96" Vertical Extrusion
2A/2B	1/1	39" Horizontal Extrusion
3	1	96" Vertical Extrusion
4A/4B	1/1	23.5" Horizontal Extrusion
5	1	96" Vertical Extrusion
6A/6B	1/1	8.5" Horizontal Extrusion
7	1	96" Vertical Extrusion
8A/8B	1/1	39" Horizontal Extrusion
9	1	96" Vertical Extrusion
10A/10B	1/1	8.5" Horizontal Extrusion
11	1	96" Vertical Extrusion

Steps:
1) Connect Horizontals to Verticals in numerical order, including **Infills**.

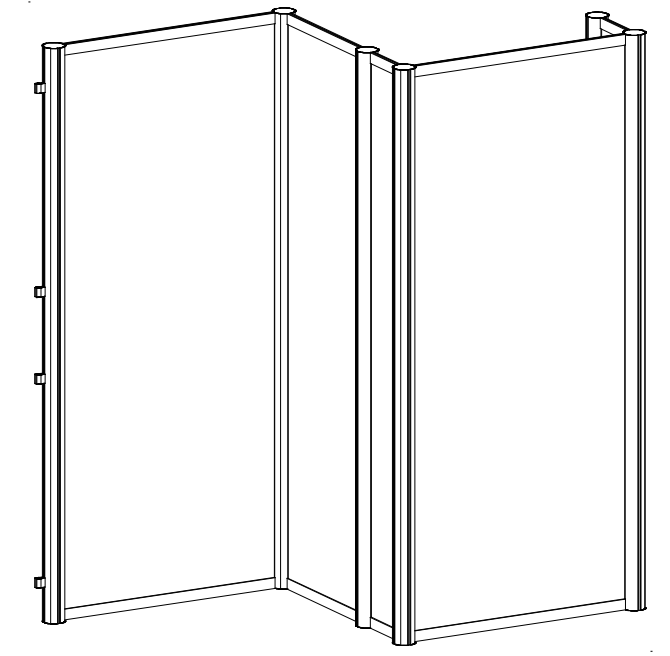
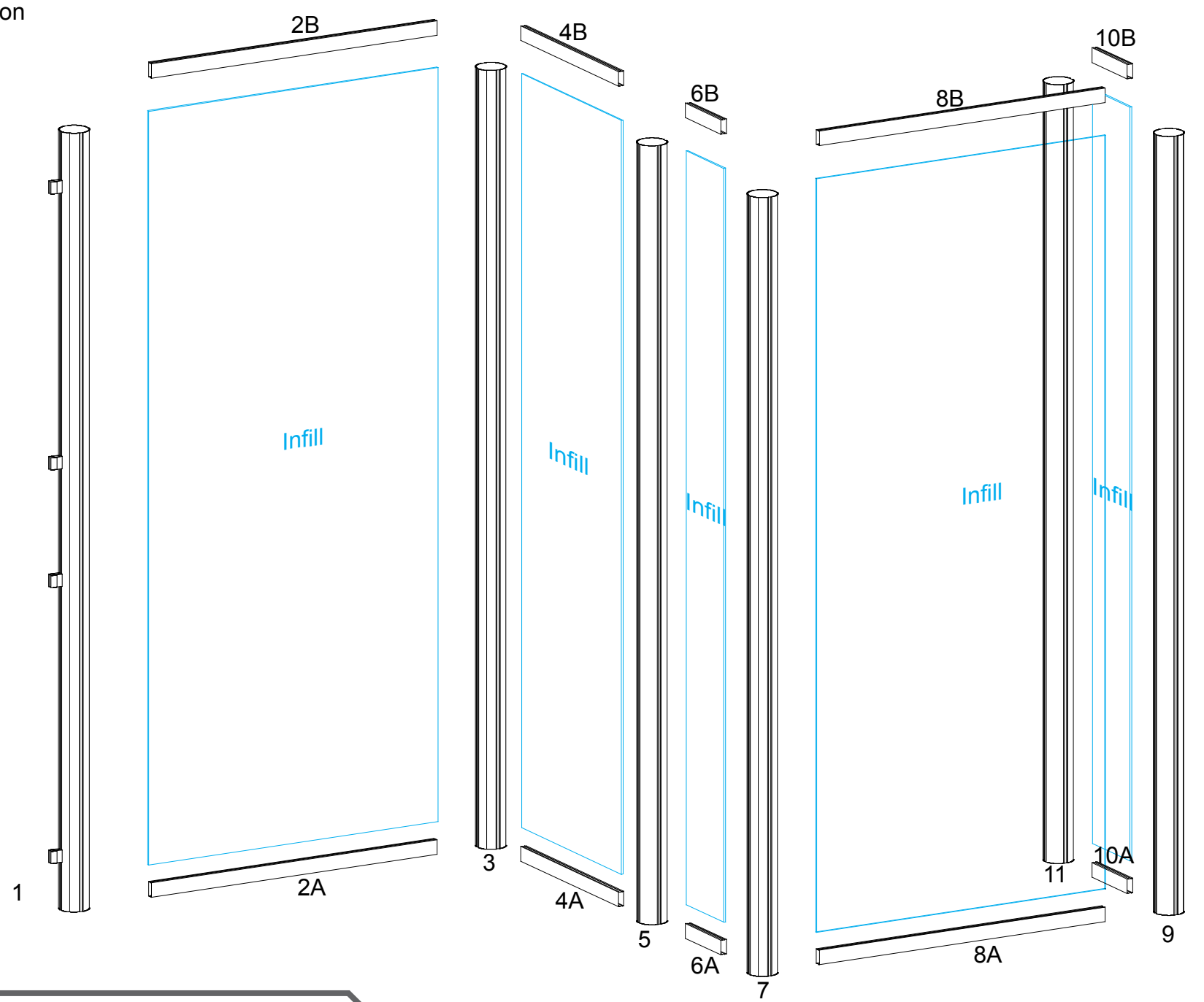

When assembled

Item	Qty.	Description
12A/12B	1/1	38.7556" Vertical Extrusion
13A/13B/13C/13D	1/1/1/1	Ceiling Support Brackets

- Steps:**
- 1) Connect Verticals [12A, 12B] between Counter Baseplate and Countertop.
 - 2) Attach Counter assembly to Verticals [5, 7].
 - 3) Attach Ceiling Support Brackets [13A, 13B, 13C, 13D] to Verticals [3, 5, 7, 9] as shown.
 - 4) Attach Ceiling A to Ceiling Support Brackets [13A, 13B].
 - 5) Attach Ceiling B to Ceiling Support Brackets [13C, 13D].
 - 6) Connect Shelves to Verticals [5, 7, 9] as shown.
 - 7) Connect Infills to Vertical [1] using A10 clamps.

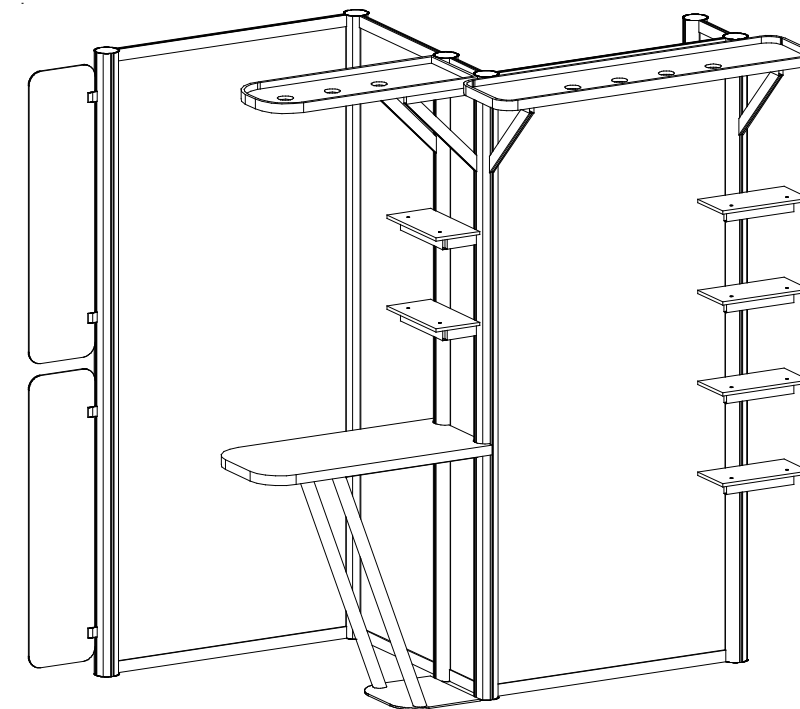
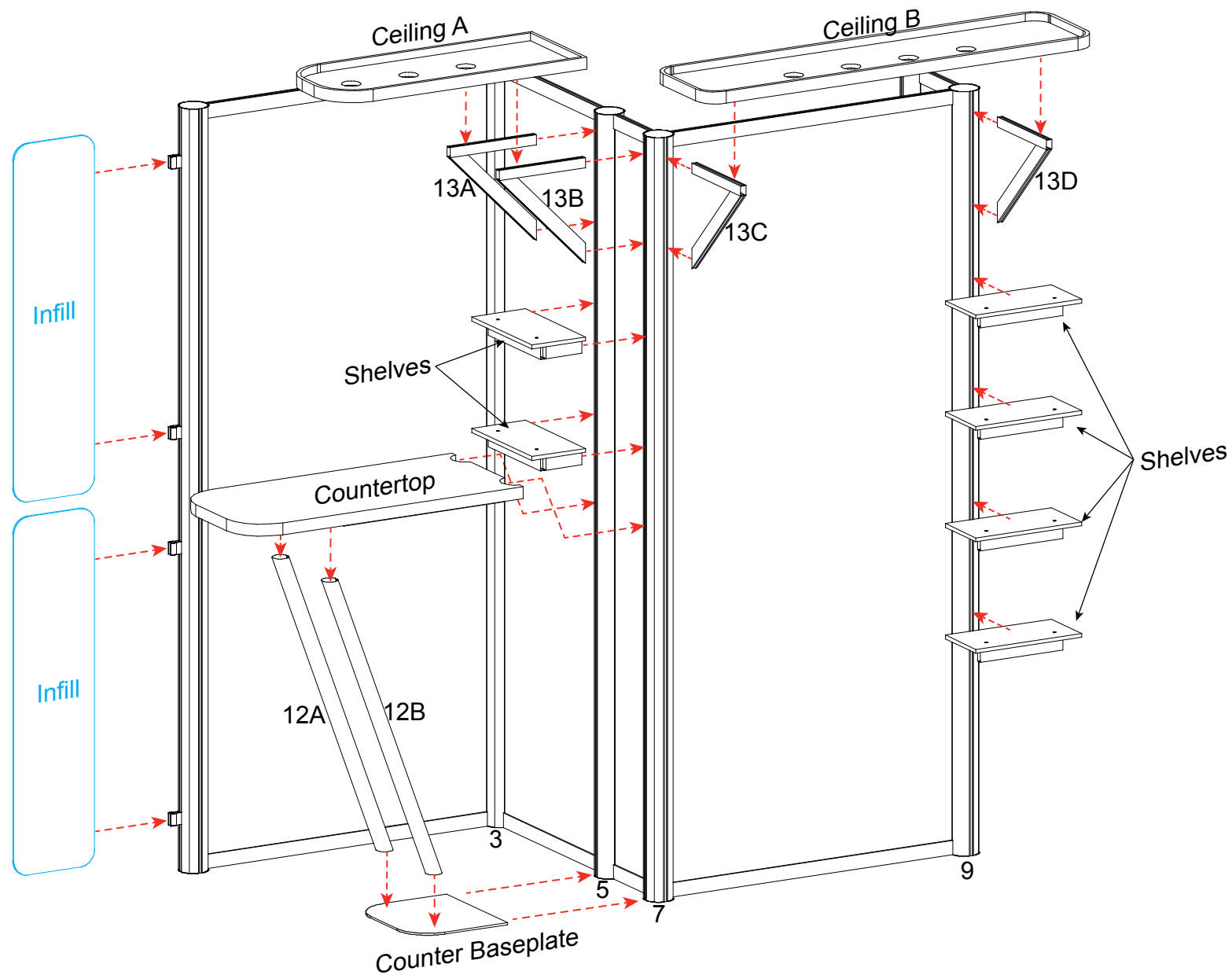

When assembled

A10 Clamp Detail

- 1) Slide A10 connector into groove of extrusion.
- 2) Tighten set screw to secure A10 to extrusion.
- 3) Insert Infill into Clamp
- 4) Tighten knob to secure wing in place.

Steps:

- 1) Connect legs to bottom of pedestal.
- 2) Connect countertop to top of pedestal with standoffs and standoff caps.
- 3) Connect front graphic to front of pedestal with standoffs and standoff caps.

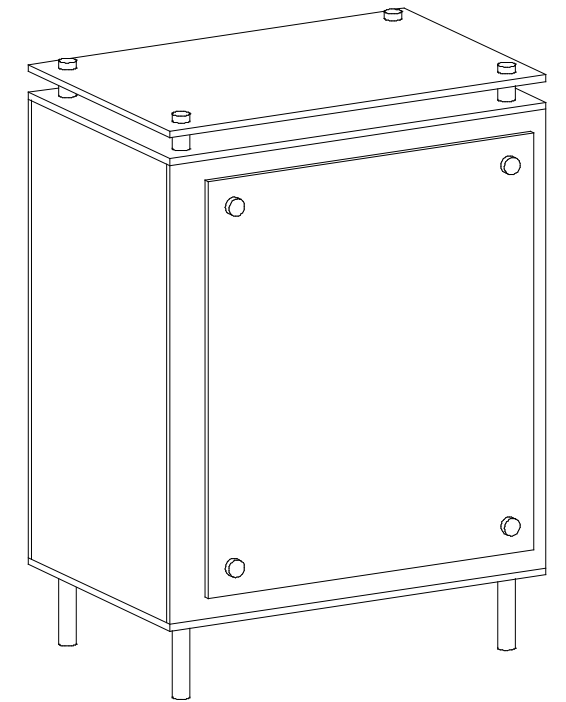
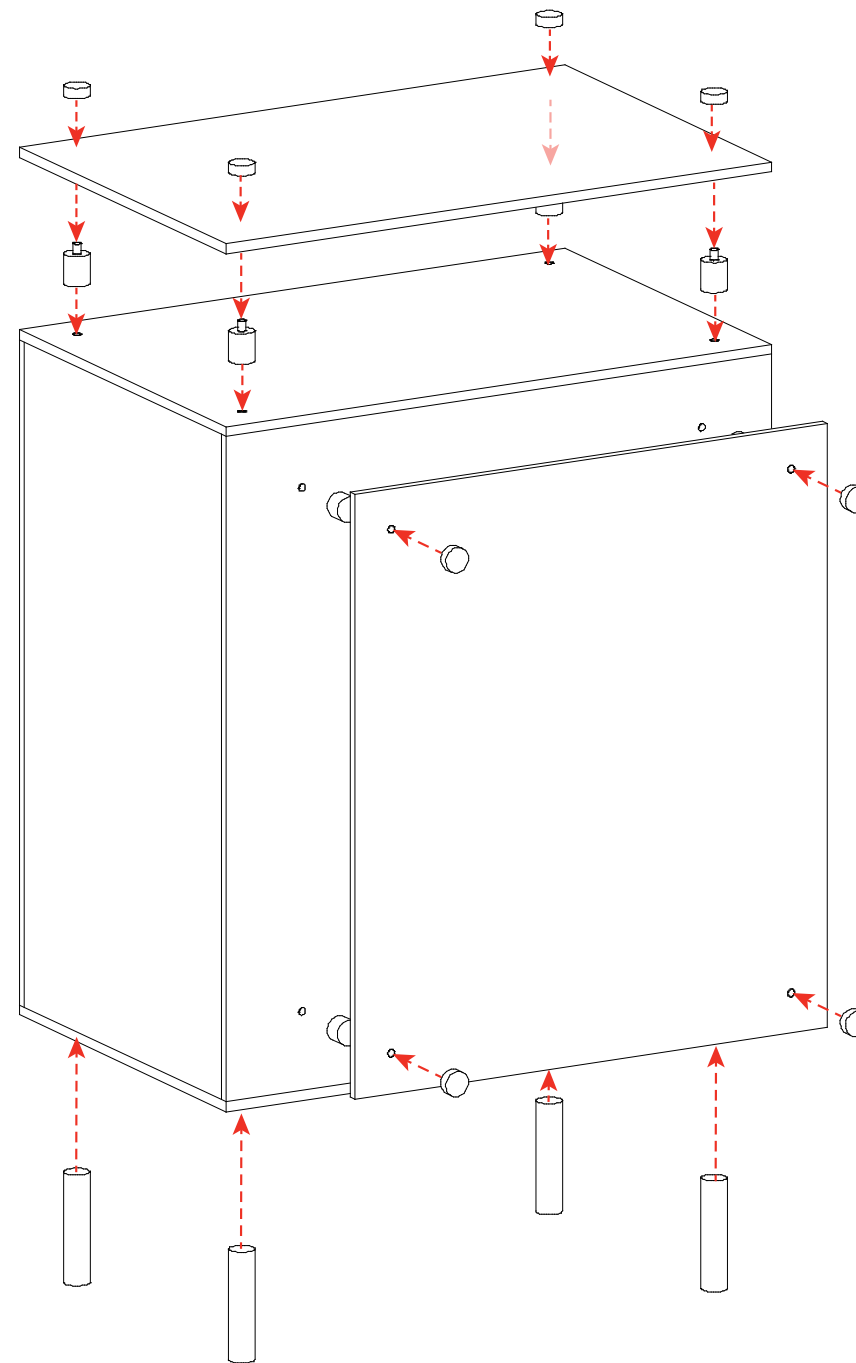

When assembled